

FS-TOT insert

compatible with Taverns of Tiefenthal®,
incl. the Open doors® (Zimmer Frei!®) expansion

Assembly Instructions

The package contains 4 sheets, two of them are identical to the other two.

The part marked in sheet A2 is to be discarded.

After assembly the trays are put in two layers in the original game box.

Ordinary PVA glue is required when assembling each tray.

Please make sure you dry-assemble each tray correctly before gluing it together.

Please check www.foldedspace.net for general assembly tips.

FS-TOT

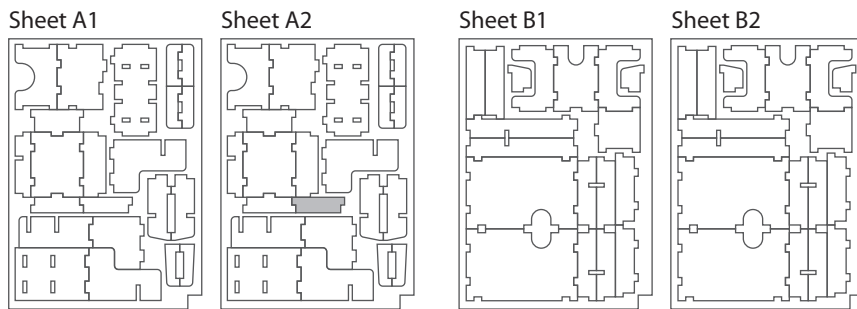
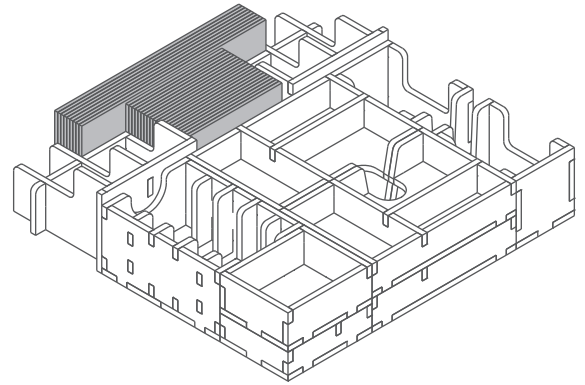

Tray 1a

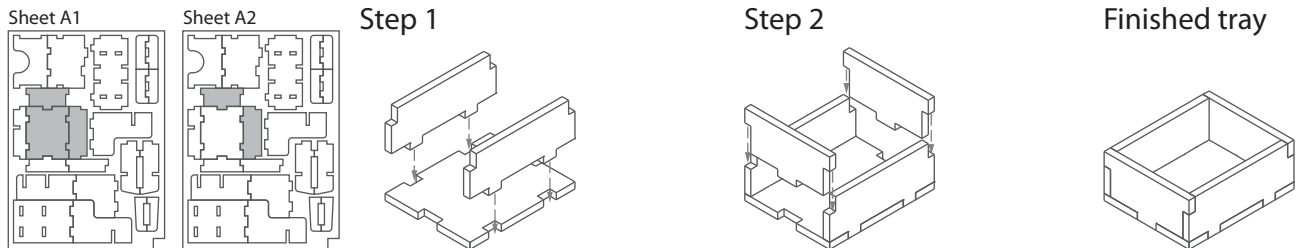

Tray 1b

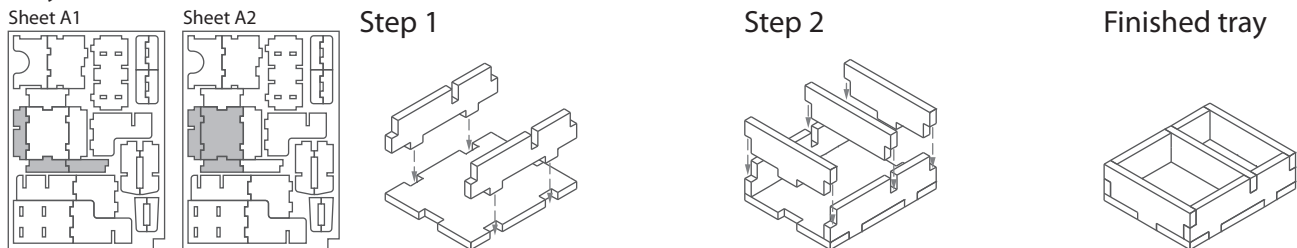

Tray 2a

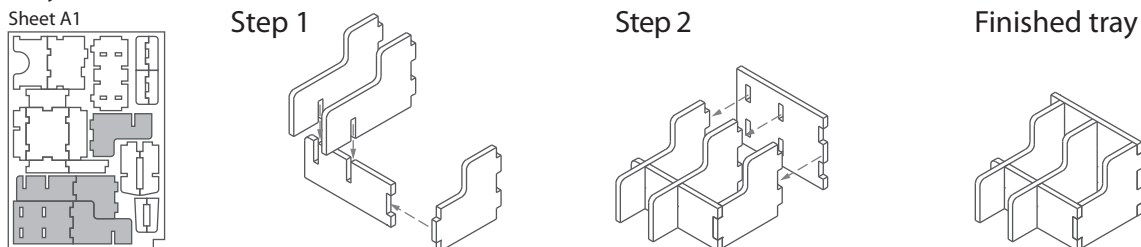

Tray 2b (the tray is a mirrored version of Tray 2a)

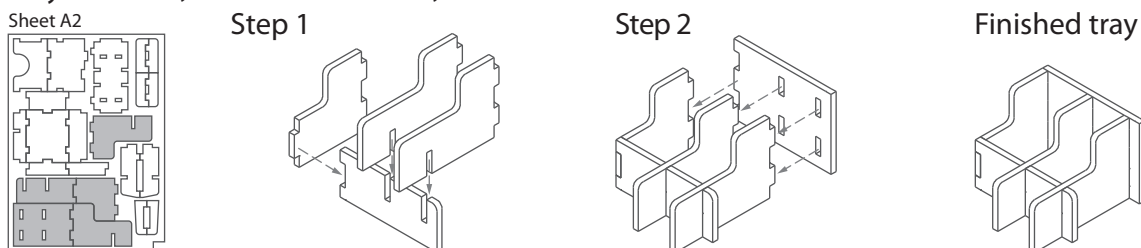

Tray 3a & 3b

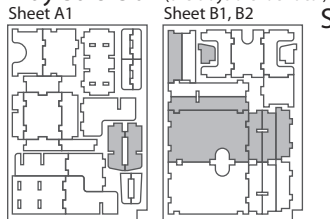

Step 1

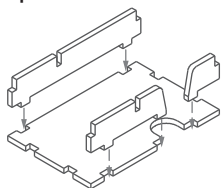

Step 2

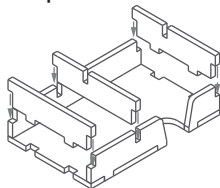

Step 3

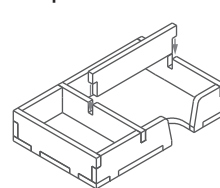

Finished tray

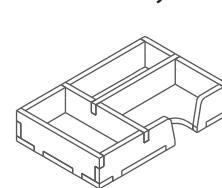

Tray 3c & 3d

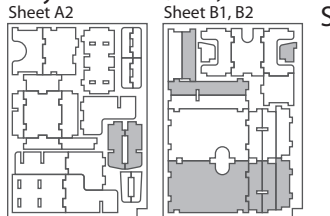

Step 1

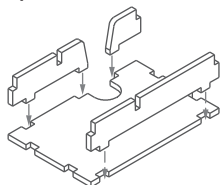

Step 2

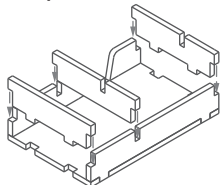

Step 3

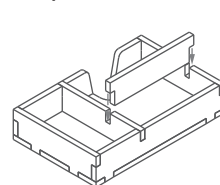

Finished tray

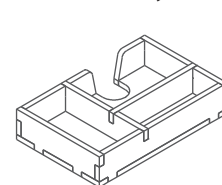

Tray 4a & 4b

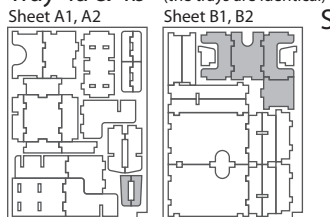

Step 1

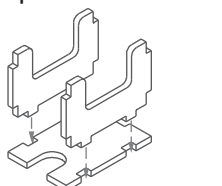

Step 2

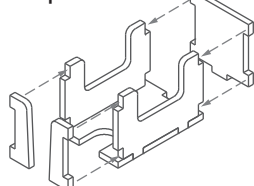

Finished tray

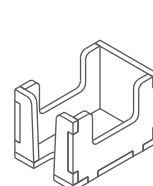

Tray 5

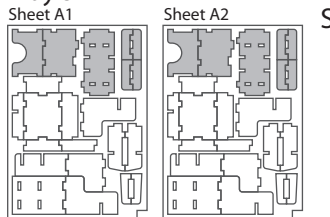

Step 1

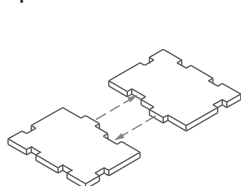

Step 2

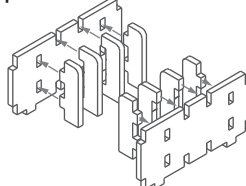

Step 3

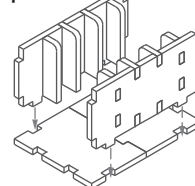

Step 4

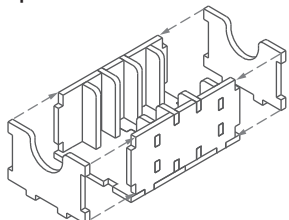

Finished tray

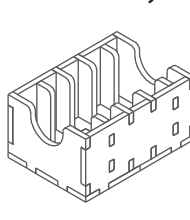

FS-TOT

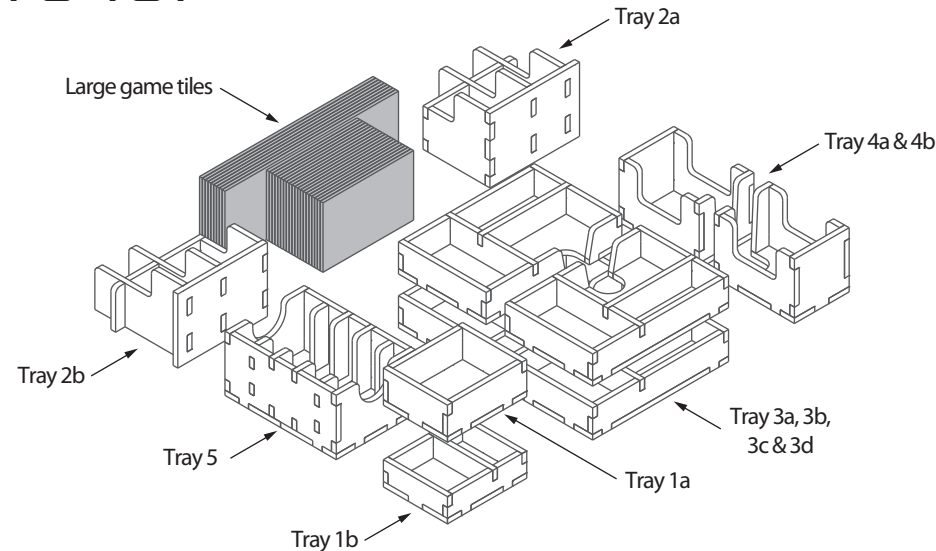

Please check www.foldedspace.net for photos of this insert in use.

Tray legend:

- Tray 1a - promissory notes
- Tray 1b - signature tiles and schnapps tokens
- Tray 2a, b - filler trays, used to position the large game tiles and to store the moon marker & beer mug token
- Tray 3a, b, c, d - player pieces
- Tray 4a - tavern cards
- Tray 4b - noble cards
- Tray 5 - other cards and host tiles

Note: the player trays have slots for the dice and wooden other markers, as well as the small tokens from the various modules. There is also one large slot for the starting regular cards and one each of all the medium sized tavern board tiles (server, beer storage, brewer, etc).