

FS-EVE insert compatible with Everdell®

incl. all Collector's Edition content and the Pearlbrook®, Spirecrest® and Bellfaire® expansions



Assembly Instructions

The package contains 6 sheets, three of them are identical to the other three.

The two parts marked in sheet C2 are to be discarded.

After assembly the trays are put in four layers in the original game box.

Ordinary PVA glue is required when assembling each tray.

Please make sure you dry-assemble each tray correctly before gluing it together.

Please check www.foldedspace.net for general assembly tips.

Note that the insert fills the game box, and it is intended that the game boards, scorepad, Ever Tree and other large tiles are stored in one of the expansion boxes.

FS-EVE

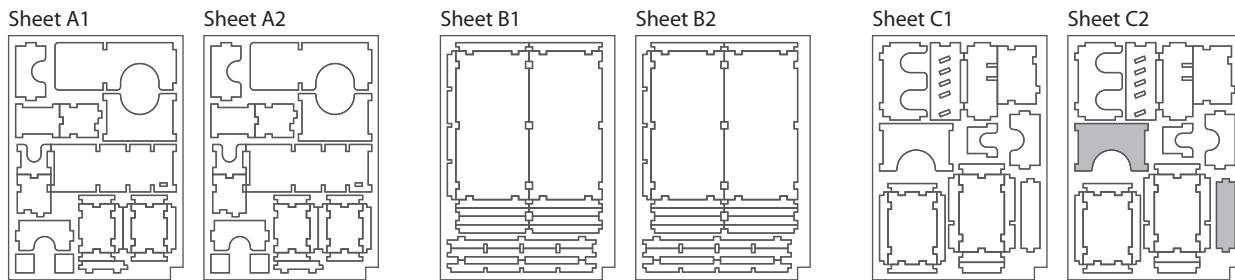
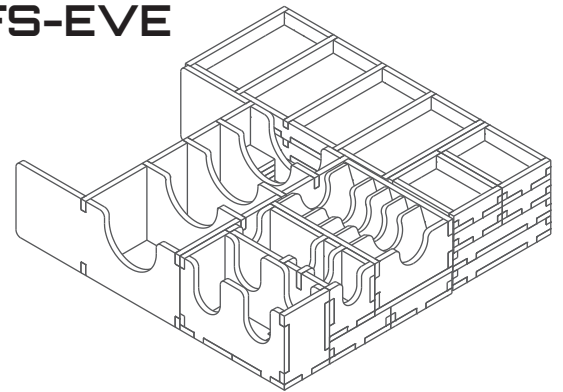

Tray 1

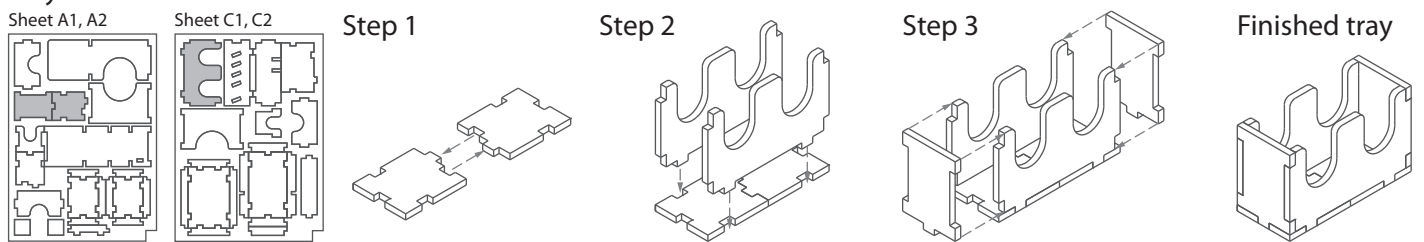

Tray 2a & 2b (the trays are identical)

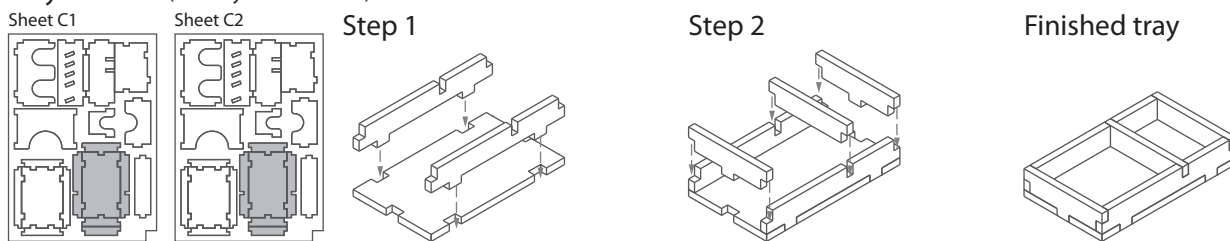

Tray 3a & 3b (the trays are identical)

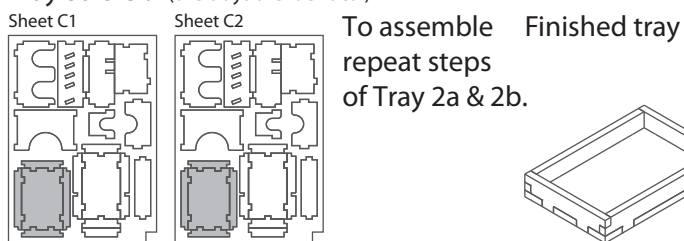

Tray 4a, 4b, 4c & 4d (the trays are identical)

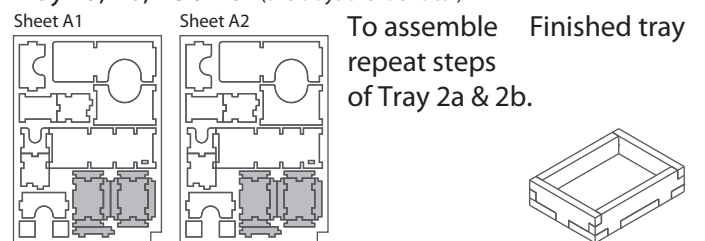

Tray 5a, 5b, 5c & 5d (the trays are identical)

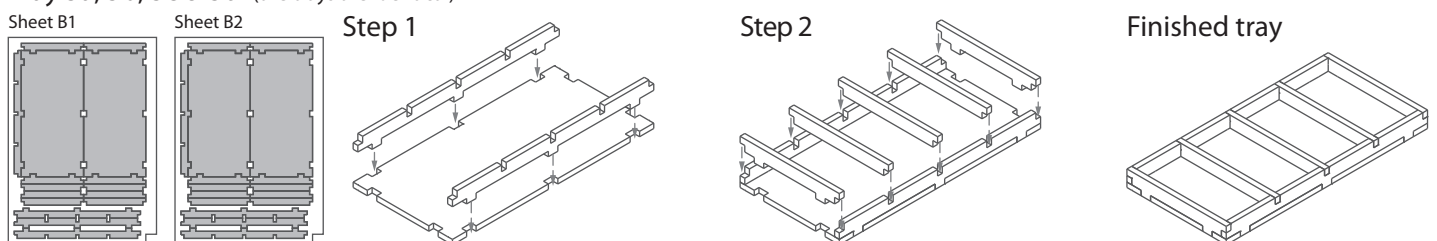

FS-EVE insert compatible with Everdell®,

incl. all Collector's Edition content and the Pearlbrook®, Spirecrest® and Bellfaire® expansions



Tray 6

Sheet A1, A2

Sheet C1, C2

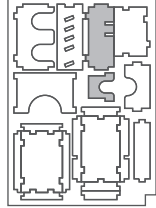
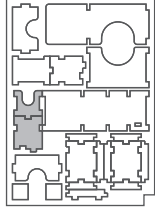

Step 1

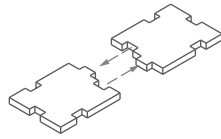

Step 2

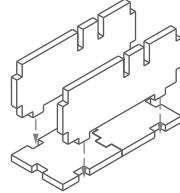

Step 3

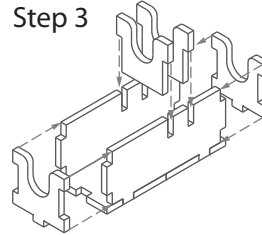

Finished tray

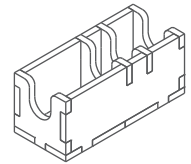

Tray 7

Sheet A1, A2

Sheet C1, C2

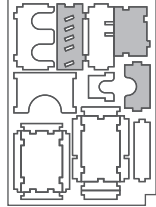
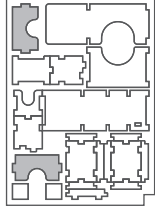

Step 1

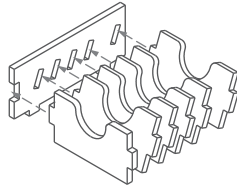

Step 2

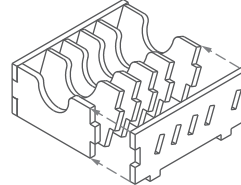

Step 3

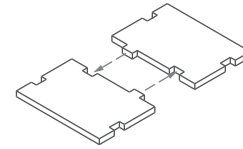

Step 4

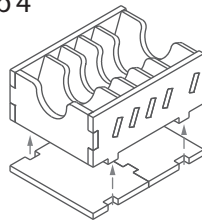

Finished tray

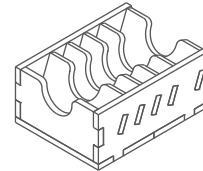

Tray 8

Sheet A1, A2

Sheet C1

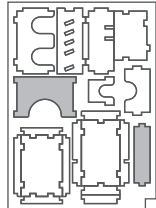
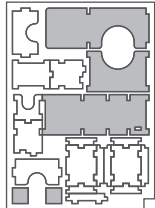

Step 1

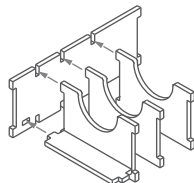

Step 2

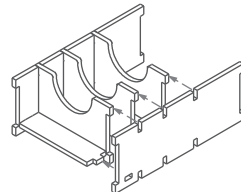

Step 3

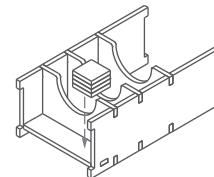

Step 4

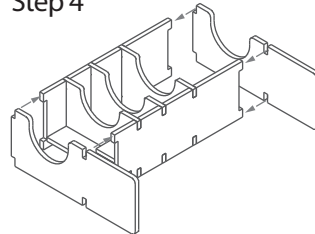

Finished tray

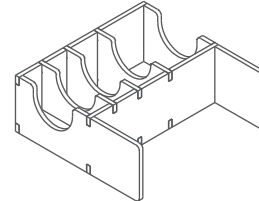

FS-EVE

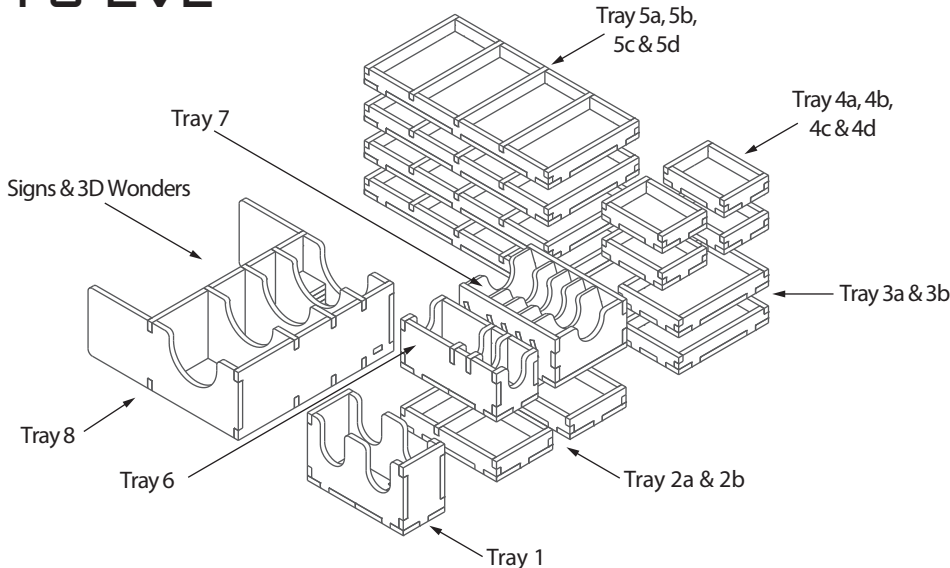

Please check www.foldedspace.net for photos of this insert in use.

Tray legend:

- Tray 1 - six of the larger big critter meeples
- Tray 2a - axolotl tokens and coins
- Tray 2b - rugwort & market tokens, and coins
- Tray 3a, b - twigs and berries
- Tray 4a, b, c, d - resin, pebbles, pearls and occupied tokens
- Tray 5a, b, c, d - critters and plastic saddles
- Tray 6 - two smaller big critter bird meeples and map tiles
- Tray 7 - small cards
- Tray 8 - large cards, event & garland award tiles, die, and signs/3D wonders standees

Note: the player power cards can either be stored in Tray 7, or added separately to each of the critter types in Trays 5.

Tip: Keep the instructions in the bottom of your board game box as a reminder of how the insert fits together.