

FS-SID insert compatible with Sidereal Confluence®



Assembly Instructions

The package contains 6 sheets, three of them are identical to the other three.

After assembly the trays are put in layers in the original game box.

Ordinary PVA glue is required when assembling each tray, for extra strength.

Please make sure you dry-assemble each tray correctly before gluing it together.

Please check www.foldedspace.net for general assembly tips.

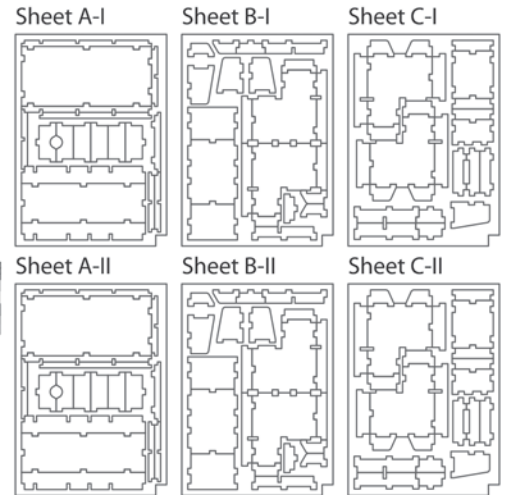
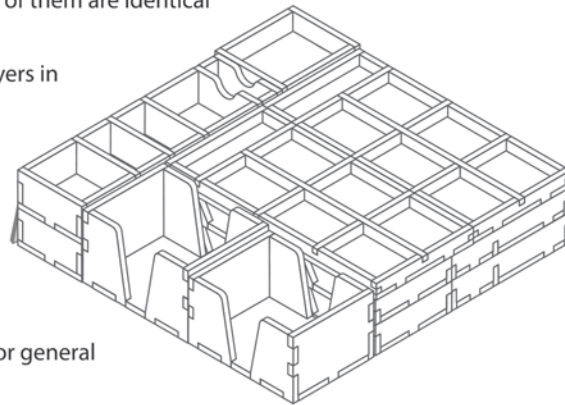

Tray 1a & 1b (the trays are identical)

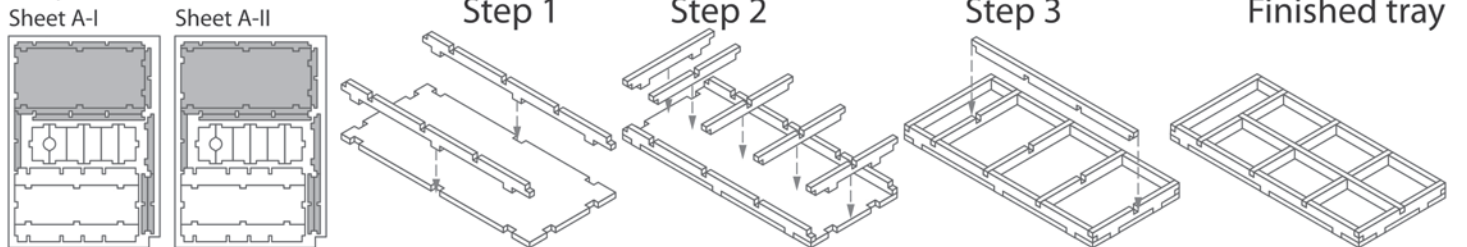

Tray 2a & 2b (the trays are identical)

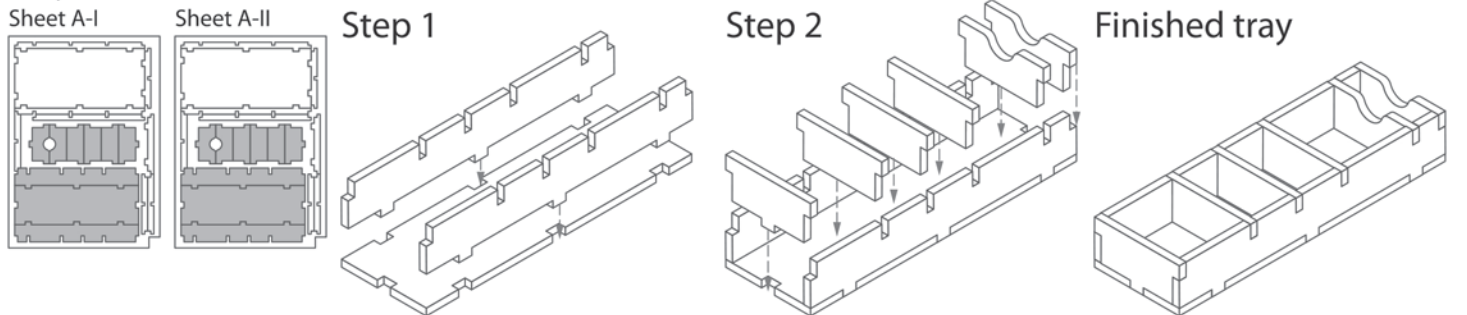

Tray 3

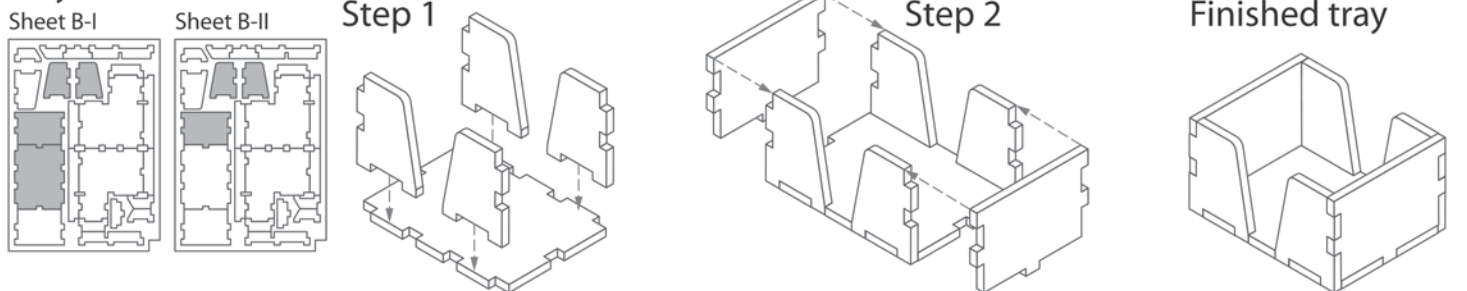

Tray 4

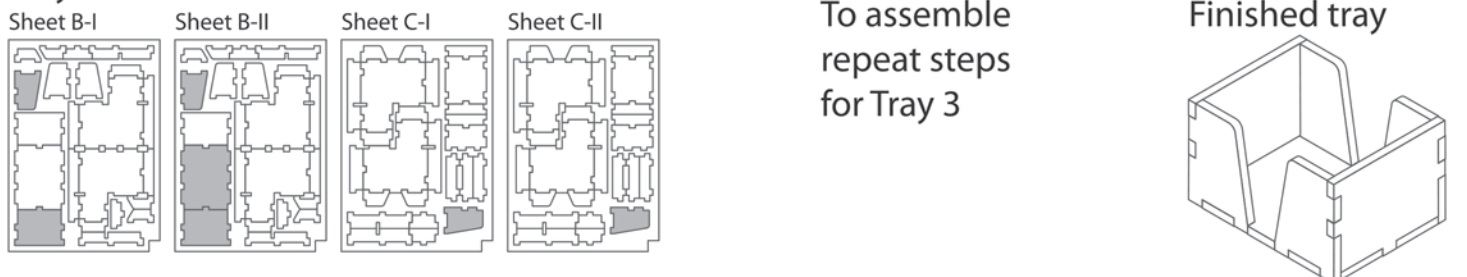

Tip: Keep the instructions in the bottom of your board game box as a reminder of how the insert fits together.

Tray 5a & 5b (identical)

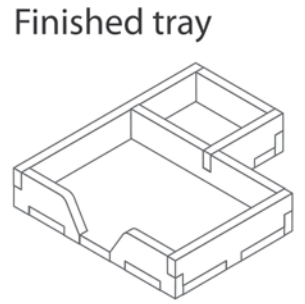
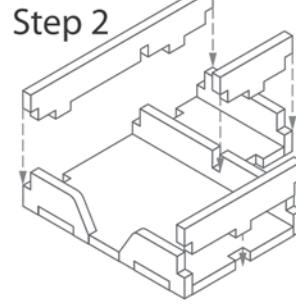
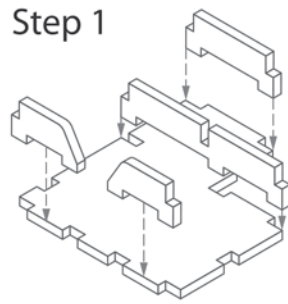
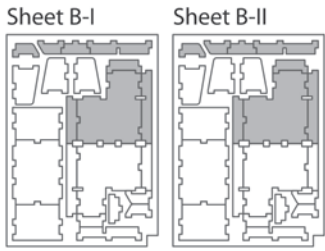

Tray 6a & 6b (identical) - Assemble as Trays 5

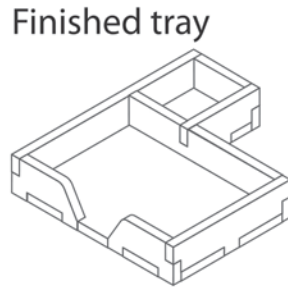
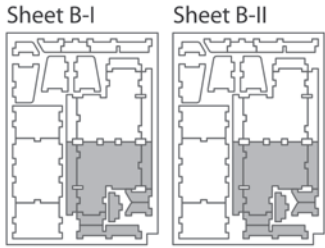

Tray 7a, b, c & d (identical) - Assemble as Trays 5

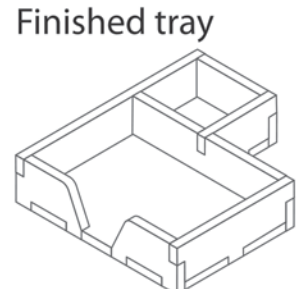
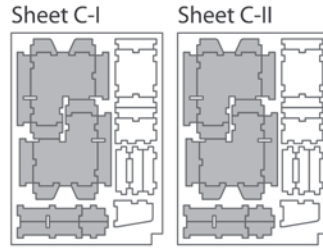

Tray 8a & 8b (identical)

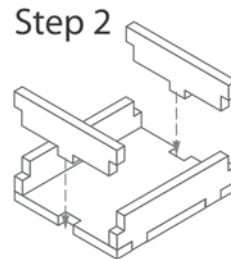
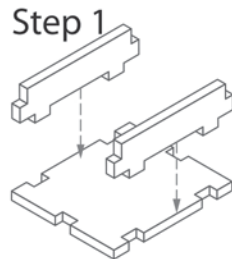
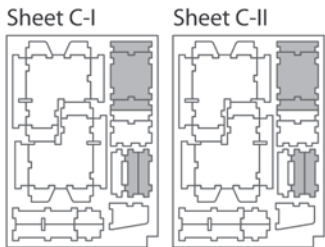

Tray 9

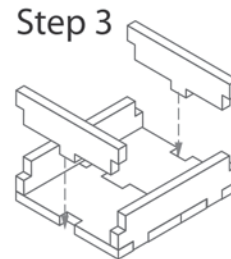
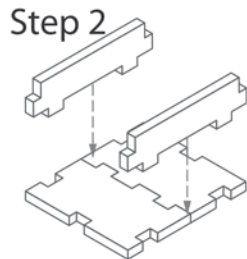
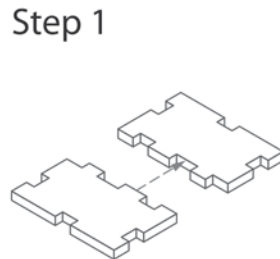
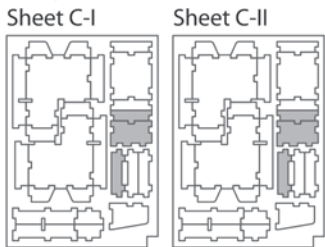

FS-SID Middle Layers

Please check www.foldedspace.net for photos of this insert in use.

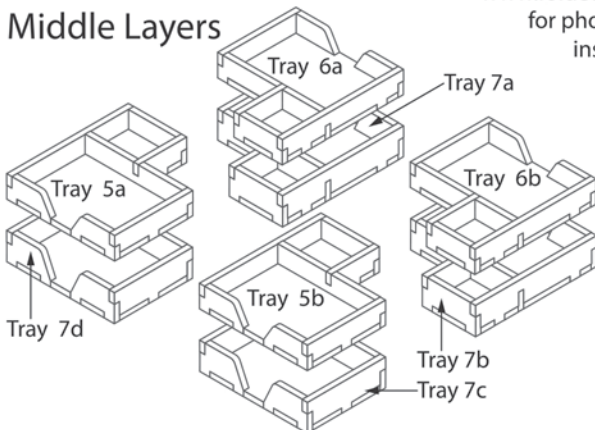

Other Layers

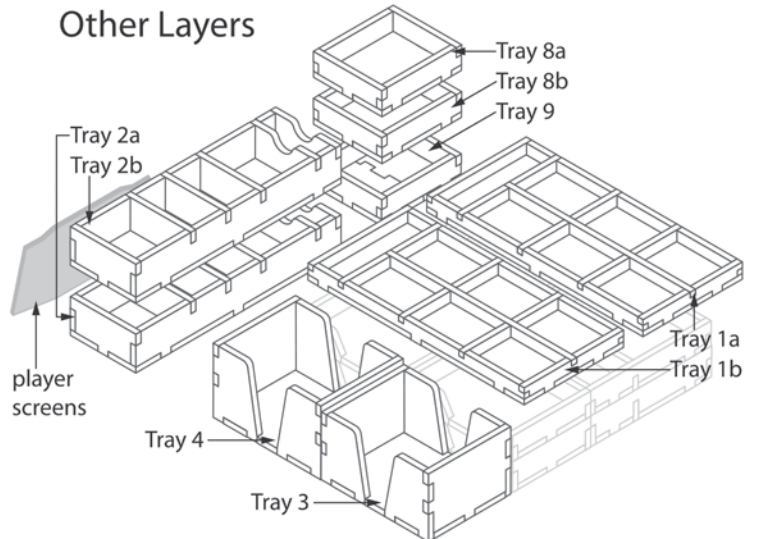

Tray legend:

- Tray 1a, b - resource cubes, ultratech
- Tray 2a, b - victory points, x5 tokens
- Tray 3 - Faderan conclave, Kt'zr'kt'rtl adhocacy cards
- Tray 4 - research + colony cards
- Tray 5a - Im'dril nomads cards + ships
- Tray 5b - Kjasjavikalimm directorate cards + ships

- Tray 6a - Caylion plutocracy cards + ships
- Tray 6b - Unity cards, Caylion seeding tokens
- Tray 7a - Eni Et ascendancy cards + ships
- Tray 7b - Yengii society cards + ships
- Tray 7c - Zeth anocracy cards + ships
- Tray 7d - track/confluence cards + Kt'zr'kt'rtl ships

- Tray 8a - Unity grey resource cubes + ships
 - Tray 8b - Faderan acknowledgements + ships
 - Tray 9 - Zeth tokens
- Note: Player screens stack vertically next to trays 2.